

FOR LEASE

Freestanding Industrial Building

1245 WEST GENEVA • TEMPE, AZ



Building Highlights

- Total Available: 13,972 SF
- Office +/- 3,000 SF
- Yard Space: +/- 19,000 SF
- Power: 1000A 120/208V
- Clear Height: 12' - 15'
- Zoning: I-2, Built in 1981
- Parking: 2.43 : 1,000 SF Leased
- Loading: 1 truck well, 1 grade level
- Broadway Industrial Park
- Sprinklered, Evaporative-Cooled Warehouse
- Close to Sky Harbor, ASU, and many retail amenities

Owned by



dctindustrial.com

Leased by



rossbrown.com

1245 WEST GENEVA DRIVE · TEMPE, AZ

FLOOR PLAN

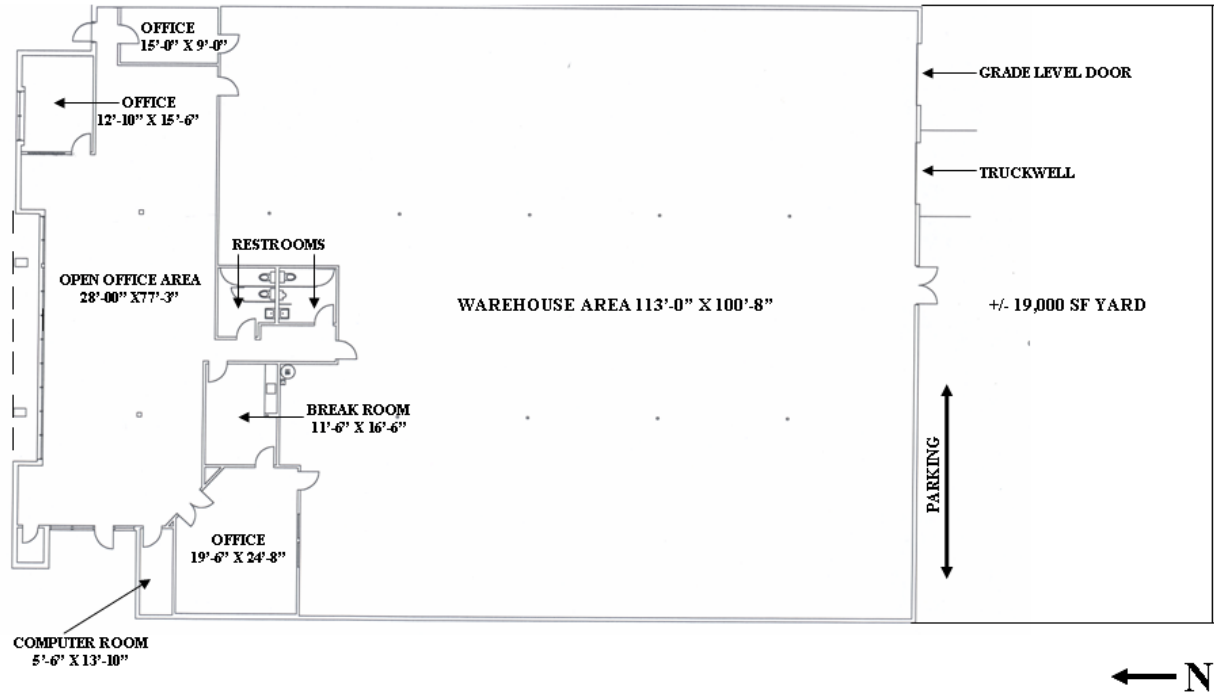

FOR ADDITIONAL INFORMATION, PLEASE CONTACT:

Curtis Brown
D: 480.362.9501
C: 602.330.3311
cbrown@rossbrown.com

Rick Collins
D: 480.362.9503
C: 480.216.8055
rcollins@rossbrown.com

Jeff Woudenberg
D: 480.362.9509
C: 480.620.8555
jeffw@rossbrown.com

