

FOR LEASE

6,107 SF Small-Bay Industrial Warehouse

1250 EAST HADLEY STREET · PHOENIX, AZ



Building Highlights

- Total Available: 6,107 SF
- Office: +/-1,200 SF
- Zoning: A-2, City of Phoenix
- Power: (1) panel 200A 120/208V
(1) panel 100A 277/480V
- Clear Height: 24'
- Column Spacing: 50' x 60'
- 6" Steel-reinforced flooring
- Loading: (1) 12'x14' grade level door
- Ample Parking
- ESFR Sprinklers, Evap-Cooled Warehouse
- Close to Sky Harbor and Downtown, with easy access to I-10 & I-17.

Owned by



dctindustrial.com

Leased by



rossbrown.com

1250 EAST HADLEY STREET · PHOENIX, AZ

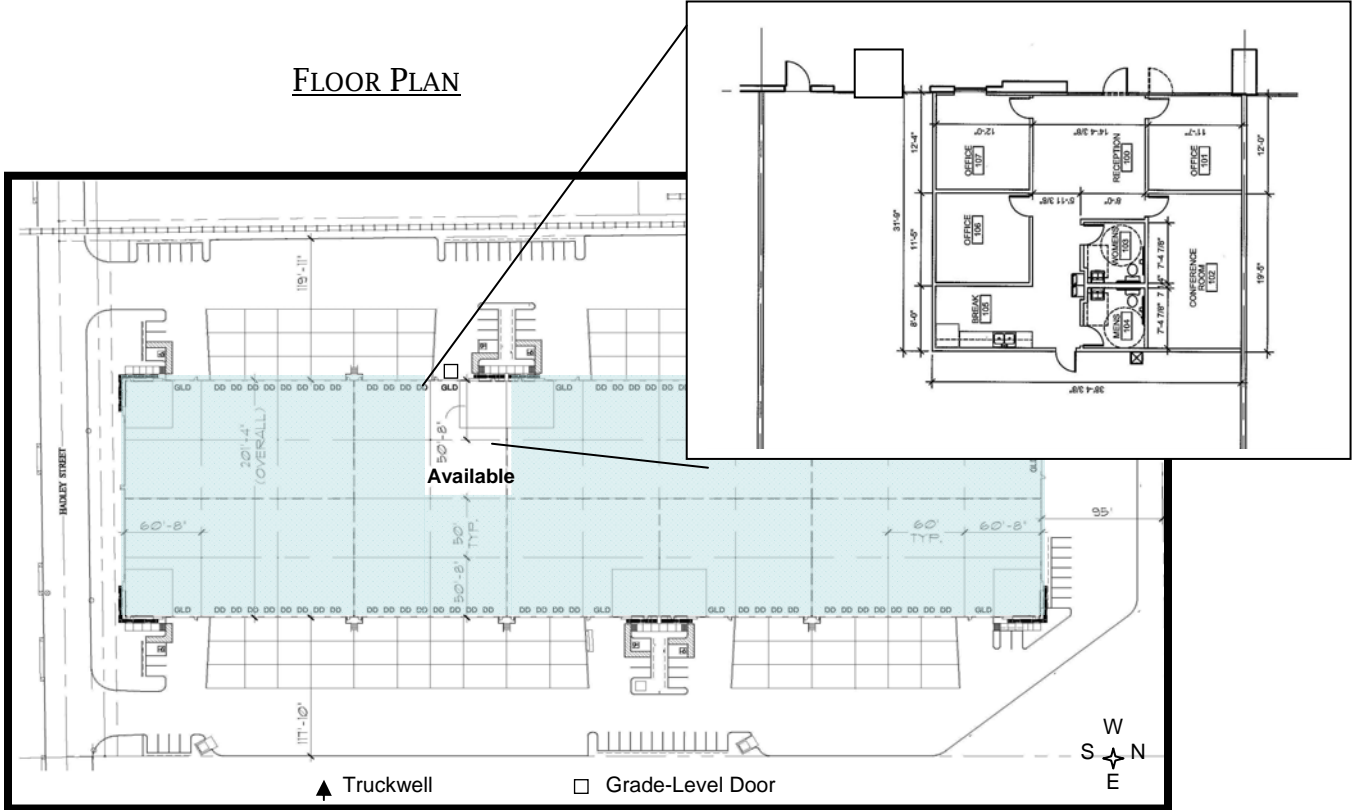

FOR ADDITIONAL INFORMATION, PLEASE CONTACT:

Curtis Brown
D: 480.362.9501
C: 602.330.3311
cbrown@rossbrown.com

Rick Collins
D: 480.362.9503
C: 480.216.8055
rcollins@rossbrown.com

Jeff Woudenberg
D: 480.362.9509
C: 480.620.8555
jeffw@rossbrown.com



The information contained herein has either been given to us by the owner of the property or obtained from sources that we deem reliable. No warranties or representations, expressed or implied, are made as to the accuracy of the information contained herein, and same is submitted subject to errors, omissions, change of price, rental or other conditions, withdrawal without notice, and to any special listings conditions, imposed by our principals. This statement with the information it contains is given with the understanding that all negotiations relating to the purchase, renting or leasing of the property described above, shall be conducted through this office.