

34,814 SF FRONT LOADED DISTRIBUTION SPACE



5333 South Kyrene Road
Tempe, Arizona

Available For Lease



Building Features

- Avail. SF: **34,814 SF**
- Bldg. SF: 69,628 SF
- Office SF: 1,800 SF
- Clear Ht: 24'
- Column Sp: 41' x 24'
- Loading: 5 Dock High Doors (10' x 10')
- Power: 400A, 277/480 V
- Zoning: GID
- Easy Access to Freeways
- Close to numerous retail amenities
- Strategic location in the Tempe Submarket

Contact:

CURTIS BROWN
480.362.9501
cbrown@rossbrown.com

BOB CRUM
480.362.9521
bcrum@rossbrown.com



A REAL ESTATE SERVICES COMPANY

5333 South Kyrene Road, Tempe, Arizona

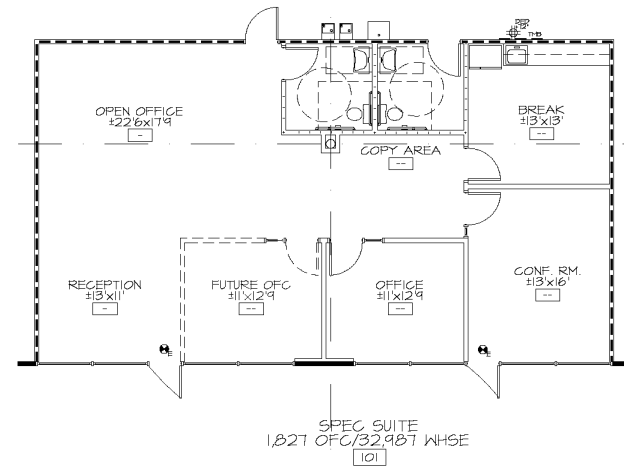
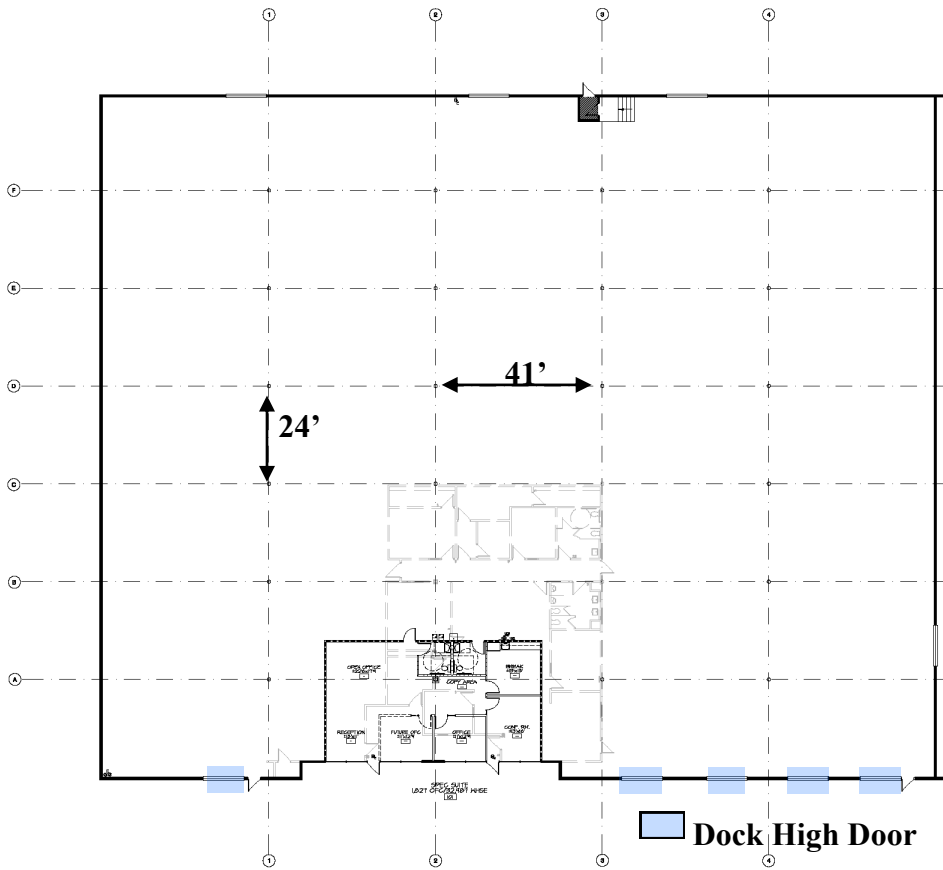

For more information contact:

CURTIS BROWN
480.362.9501
cbrown@rossbrown.com

BOB CRUM
480.362.9521
bcrum@rossbrown.com

RICHARD MACKAY
480.362.9507
rmackay@rossbrown.com



The information contained herein has either been given to us by the owner of the property or obtained from sources that we deem reliable. No warranties or representations, expressed or implied, are made as to the accuracy of the information contained herein.

A REAL ESTATE SERVICES COMPANY